

Secure, convenient and durable products - our storage & ground-level containers

* floorplans and dimensions are approximate

8'x20' storage container

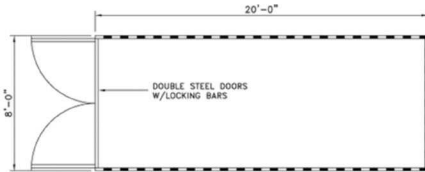

20' long
8' wide
8' under ceiling
app. 5,300 lbs.

8'x40' storage container

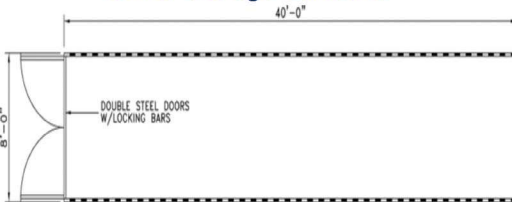

40' long
8' wide
8' under ceiling
app. 8,500 lbs.

8'x20' container office

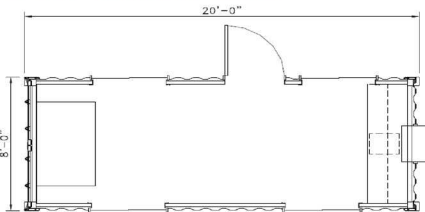

20' long
8' wide
7'-6" ceiling
app. 5,300 lbs.

8'x40' container office

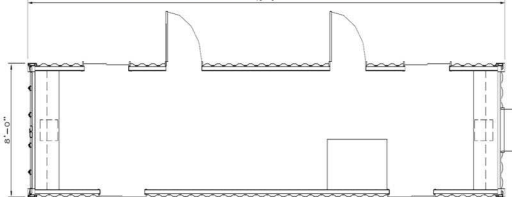

40' long
8' wide
7'-6" ceiling
app. 8,500 lbs.

8'x40' container O/S combo

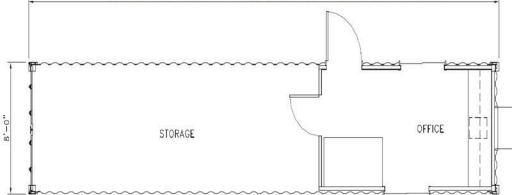

40' long
8' wide
7'-6" ceiling
app. 8,500 lbs.

Storage containers

- Constructed of gauge steel
- 1 1/4" marine wood plank floor
- Steel reinforcement crossbeams under floor
- Wide, easy to open double doors
- High security locking system
- Ground level entry

On-grounds

- ISO certified
- Fully welded core-ten steel exterior
- Pre-finished walls
- 1/8" vinyl floor tile or 1 1/4" marine wood plank floor
- Horizontal sliding window with steel guards

- Commercial steel door with Hockey-Puck-Locks included
- Rear door: Master and Hockey Puck-Locks Available
- Central HVAC
- Fluorescent lighting
- Built-in desk with file cabinet
- Built-in plan table